



**3, 4,  
5, 6**

( ) 3, 4, 5, 6  
 ( 3, 4, 5) 6 2- 3  
 .364.215 .  
 3 (4- 7- )  
 3 .364.047 . 6  
 , -5 - , 4 -

.1.

.364.215 ( .434410.104 ) .

3(4,5,6)	4(7,10,19,32, 50)	1( )	1(1...12)
1 -			
( 3 10- , 19- )			

" " (« »),

3-10-1-1- .364.215  
 4-13-1-2- .364.215  
 5-32-1-2- .364.215  
 6-50- -7- .364.215

	3	4	5	6
	30	30	30	60







0,2 (2 / 2), 3 -1 ( . . -1) 5000 . 1  
 ( ) 200  
 - 3 10<sup>-3</sup> (3 10<sup>-5</sup>)  
 250  
 , 200<sup>0</sup> : 1000  
 , 15

∴ , / 2 (g)	1-5000 600 (60)	, <sup>0</sup>	100
		, <sup>0</sup>	60
∴ , / 2 (g)	10000 (1000)	, ( . .)	1,34 10 <sup>-10</sup> (1 10 <sup>-12</sup> )
∴ , / 2 (g)	2000 (200)		

200 <sup>0</sup> ,	, <sup>0</sup>
1000	120
3000	102
5000	94
7500	88
10000	84
150000	78
200000	75
25000	72
30000	69
40000	65
50000	63
80000	57
100000	54
130000	51

, %	, <sup>0</sup>
100	20
90	18
80	17
70	14
50	10
40	8
30	6
20	4

1

1	2	3	4	5	6
10		4	1,5	2	6
12		7			10
14		10			15
18		19	1,1		20
22		32	0,9		28
27		50	0,7		35

3

2

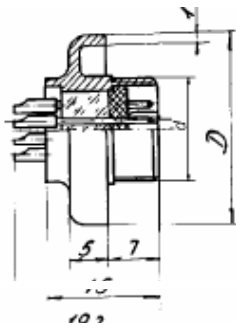

	d	D
3-4-1-1-	10 0,75	17,4
3-7-1-1-	12 0,75	19,4
3-10-1-1-	14 0,75	25
3-19-1-1-	18 1	29
3-32-1-1-	22 1	33
3-50-1-1-	27 1	38

4

3

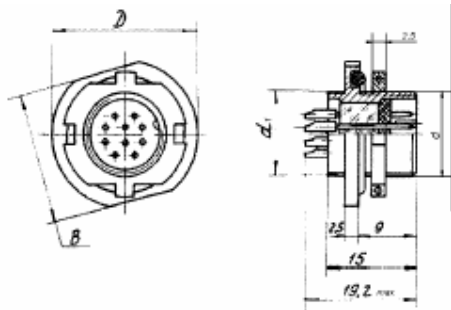

	d1	d	D	B
4-10-1-1-	14 0,75	14 0,75	25	22
4-19-1-1-	18 0,75	18 1,0	29	26
4-32-1-1-	22 0,75	22 1,0	33	30
4-50-1-1-	27 0,75	27 1,0	38	35

5

4

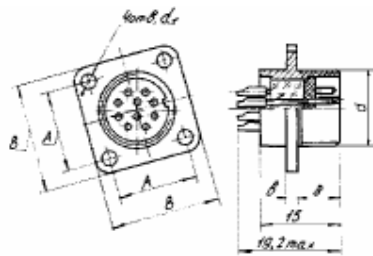

	d	d1	A	B	
5-10-1-1-	14	2,2	15	20	1,8
5-19-1-1-	18	2,7	18	24	2
5-32-1-1-	22	2,7	21,5	28	2
5-50-1-1-	27	3,2	26	33	2

6

5

